

SET-60 with Bendheim Wall Systems

BENDHEIM WALL SYSTEMS

LINIT Channel Glass by Lamberts

New project photos... [Click Here!](#)



Channel glass — up to 23' tall, available tempered or annealed, in four surface textures, low iron, enameled colors, or selectively sandblasted. Lamberts channel glass choices are almost unlimited.

Our team of engineers and installation professionals will work with you from concept to completion, insuring the channel glass wall system you specify meets or exceeds design and performance objectives.

The Glasfabrik Lamberts is the largest independently held glass factory in Europe. Protection of the environment is a top priority for the company. Their sophisticated oxygen/fuel fired cast glass furnace is the only one of its type in Europe.

[find out more >](#)

[SGCC](#) certified tempered glass available!



[contact us](#)



[product info](#)



[projects](#)

See it in
Sweet's
printed
catalog
08900/BEN



© BENDHEIM WALL SYSTEMS 2007. All rights reserved.

Union Square Job (under construction)

- Lighting up two sides of building on 6th floor
- (20) 11 ft long X 12 inch wide vertical lighting panels
- **SET-60** modules sandwiched between Bendheim Channel glass blocks



Union Square Job

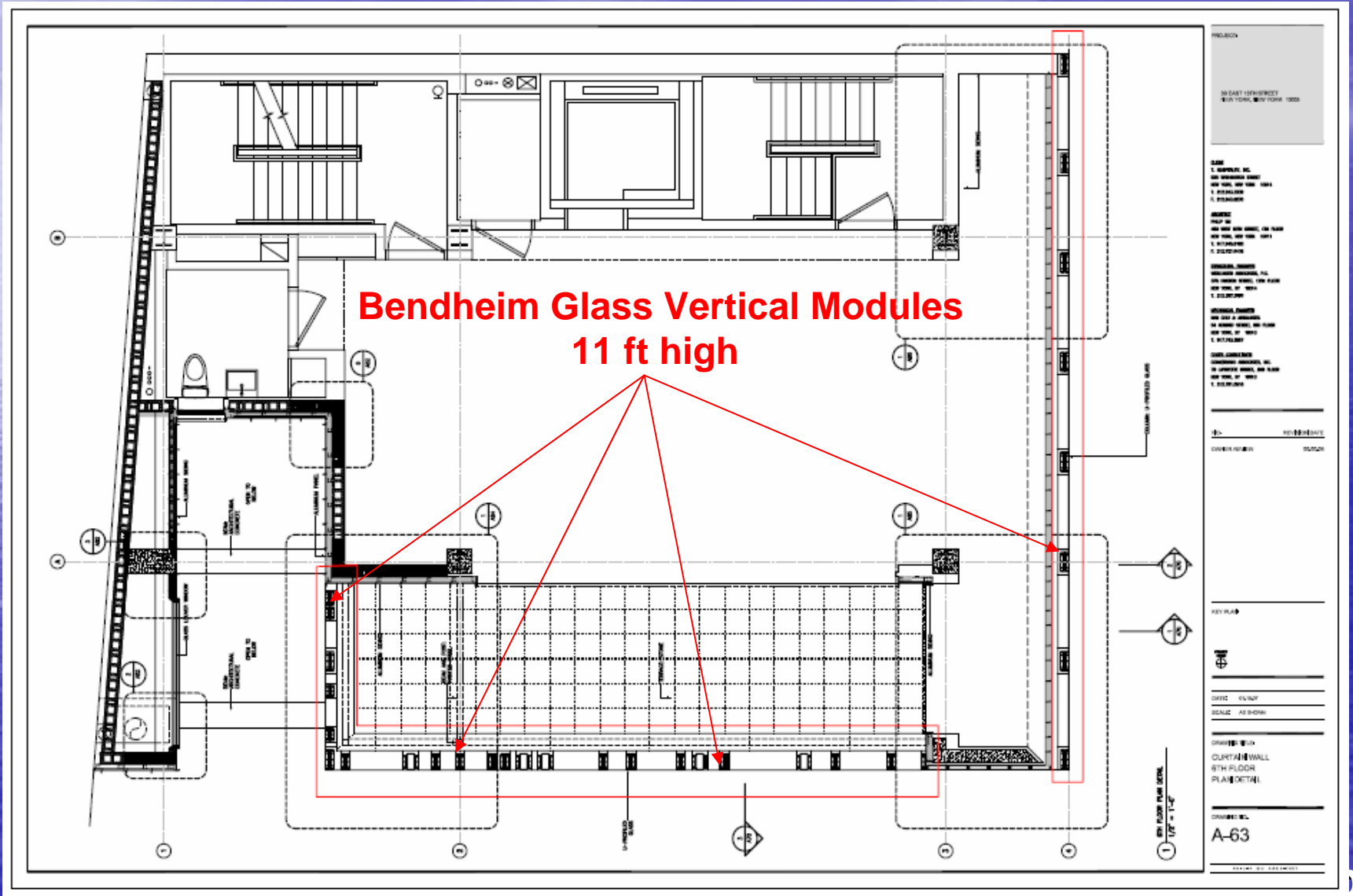

Union Square Job

11 ft X 12 inch Bendheim glass vertical modules



SET-60 Module Sandwiched between Bendheim Glass Panels

